

MAXISPAN CHAIN

MaxiSpan chain is adaptable in design and a top choice for its product cooling capabilities. The innovative MaxiSpan chain is modular in design and could cost you less.

MaxiSpan utilizes a 75 percent open design. Liquids and debris are able to fall through the chain meaning there is less downtime due to conveyor cleaning. The MaxiSpan's open design also equals cost savings, due to reduced material use. Horizontal curves, inclines, declines, and straight sections are all possible in one continuous conveyor, often eliminating the need for transfers. The modular design also allows for individual sections of the chain to be opened making service and maintenance a breeze.

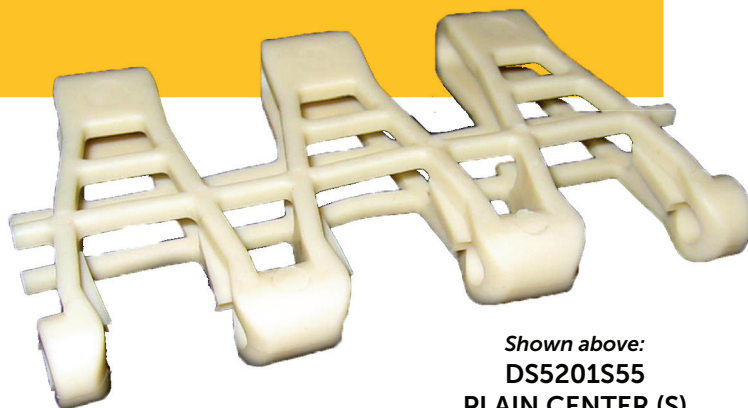

Shown above:
DS5201S55
PLAIN CENTER (S)

CHAIN OPTIONS:

- Plain
- Raised Top
- Moving Side Guide
- Pusher Cleat
- Pusher w/ Moving Side Guide

PITCH

- 50mm

AVAILABLE WIDTH RANGE

- 209.8mm - 1209.2mm

MATERIAL OPTIONS

Available in materials resistant to most chemicals and temperatures ranging from -40° to 220° F

USDA APPROVED

BISSC CERTIFIED



Perfect for cooling and metal detectors applications.

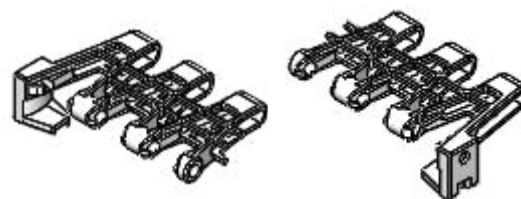

DS5210A - LH PLAIN (A)
DS5230A - RH PLAIN (A)

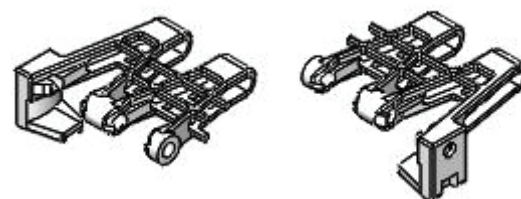

DS5210A-2/3 - LH PLAIN (A) 2/3
DS5230A-2/3 - RH PLAIN (A) 2/3



DS5212A - LH 6MM RAISED (A)
DS5232A - RH 6MM RAISED (A)

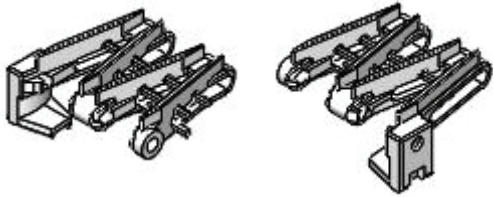

DS5212A-2/3 - LH 6MM RAISED (A) 2/3
DS5232A-2/3 - RH 6MM RAISE (A) 2/3

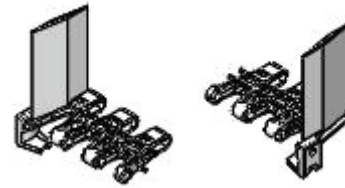

DS5214A - LH 75MM MSG
DS5234A - RH 75MM MSG

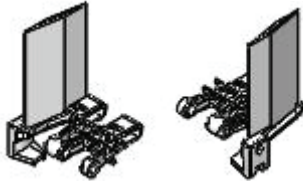

DS5214A-2/3 - LH 75MM MSG (A) 2/3
DS5234A-2/3 - RH 75MM MSG (A) 2/3

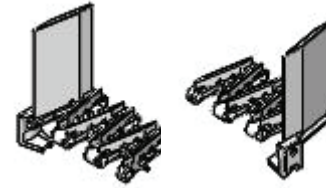

DS5216A - LH 6MM RAISED / 75MM MSG
DS5236A - RH 6MM RAISED / 75MM MSG

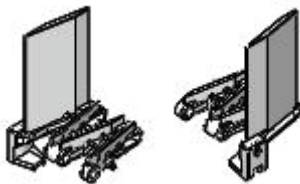

DS5216A-2/3 - LH 6MM RAISED / 75MM MSG
DS5236A-2/3 - RH 6MM RAISED / 75MM MSG



DS5218A - LH 30MM MSG (A)
DS5238A - RH 30MM MSG (A)

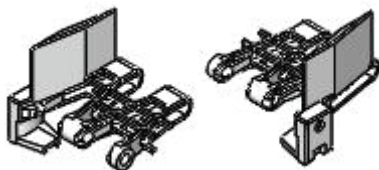

DS5218A-2/3 - LH 30MM MSG (A)
DS5238A-2/3 - RH 30MM MSG (A)



DS5220A - LH 6MM / 30MM MSG
DS5240A - RH 6MM / 30MM MSG

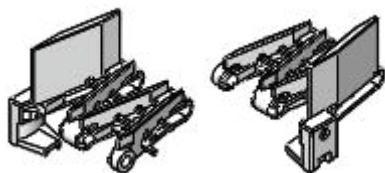

DS5220A-2/3 - LH 6MM RAISED / 30MM MSG 2/3
DS5240A-2/3 - RH 6MM RAISED / 30MM MSG 2/3

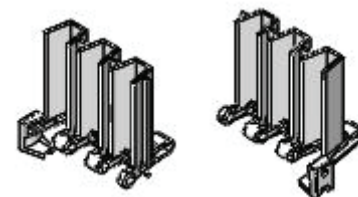

DS5222A - LH 75MM PUSHER CLEAT (A)
DS5242A - RH 75MM PUSHER CLEAT (A)

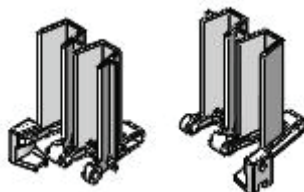

DS5222A-2/3 - LH 75MM PUSHER CLEAT (A) 2/3
DS5242A-2/3 - RH 75MM PUSHER CLEAT (A) 2/3

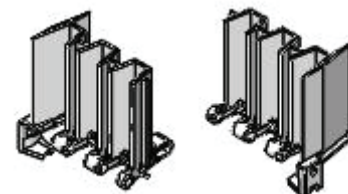

DS5224A - LH 75MM PUSHER CLEAT / MSG
DS5244A - RH 75MM PUSHER CLEAT / MSG



MaxiSpan Chain is perfect for the food & beverage industry.

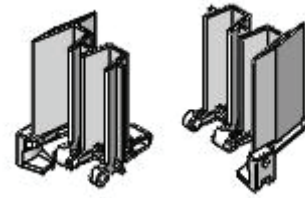

DS5224A-2/3 - LH 75MM PUSHER / MSG 2/3
DS5244A-2/3 - RH 75MM PUSHER / MSG 2/3



DS5205A - 75MM CENTER PUSHER (A)
DS5205A-2/3 - 75MM CENTER PUSHER (A) 2/3
DS5205A-1/3 - 75MM CENTER PUSHER (A) 1/3

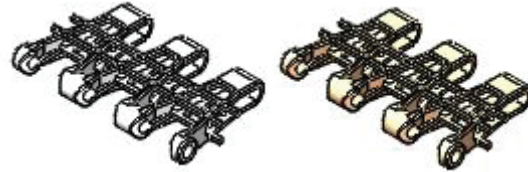

DS5201A - PLAIN CENTER (A)
DS5201S55 - PLAIN CENTER 55D (S)

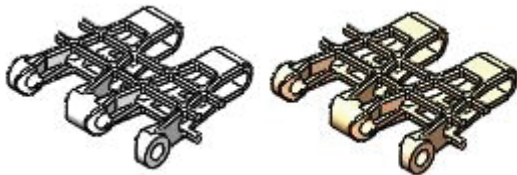

DS5201A-2/3 - PLAIN CENTER (A) 2/3
DS5201S55 - PLAIN CENTER 55D (S) 2/3

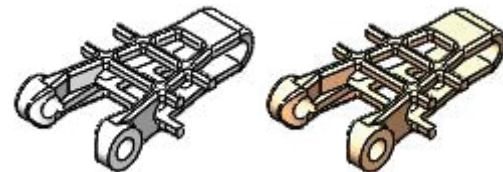

DS5201A-1/3 - PLAIN CENTER (A) 1/3
DS5201S55-1/3 - PLAIN CENTER 55D (S) 1/3

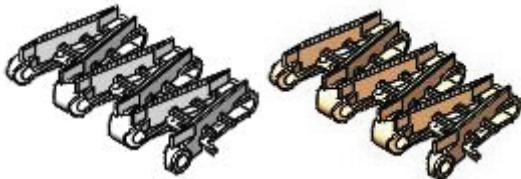

DS5203A - 6MM RAISED CENTER (A)
DS5203S55 - 6MM RAISED CENTER 55D (S)

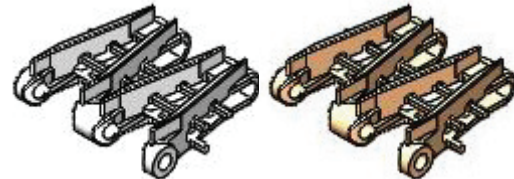

DS5203A-2/3 - 6MM RAISED CENTER (A) 2/3
DS5203S55-2/3 - 6MM RAISED CENTER 55D (S) 2/3

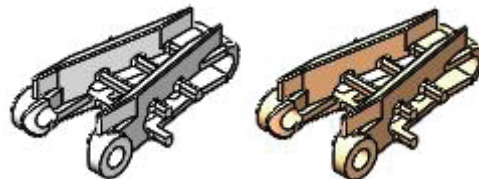

DS5203A-1/3 - 6MM RAISED CENTER (A) 1/3
DS5203S55-1/3 - 6MM RAISED CENTER 55D (S) 1/3

The above information has been provided as guidelines only, and does not represent all design variations possible. For detailed or specific design requirements, please contact a representative.